

MULTI-CON-X<sup>®</sup>  
**INSTA-CLICK<sup>®</sup>**  
SEALED CONNECTORS



**Switchcraft<sup>®</sup>**  
**CONXALL<sup>®</sup>**

HARSH ENVIRONMENT CONNECTIVITY SOLUTIONS

# Multi-Con-X® Insta-Click® Sealed Connectors

Insta-Click® spring loaded latching mechanism locks automatically. Easily disconnect with a quarter turn of the coupling ring



Available as field installable connectors or factory molded cable assemblies

Thousands of configurations are available up to 12 contacts with a variety of options, including mixed contact sizes



Insta-Click® connectors mate only with other Insta-Click® series products

## NEW PRODUCT

The Multi-Con-X® from Conxall® has set the standard for harsh environment connectors, and the new Insta-Click® product line adds several key improvements for even harsher environments. An all-new latching mechanism provides an automatic positive lock while improving the water resistance rating to IP68 (when used as part of a molded cable assembly). A high quality new plastic offers UV resistance.

**IP68**  
RATED WATER  
RESISTANCE

The Conxall® Insta-Click® series is sealed to IP68 for harsh environments when used with a molded cable assembly.

**UL F1**  
RATED UV  
RESISTANCE

A special high-PBT material provides excellent UV resistance for outdoor use and lighting applications

  
**CONXALL**  
QUALITY

Made in USA to the high standards that have made Conxall the leading name in harsh environment connectors.

VISIT [WWW.SWITCHCRAFT.COM](http://WWW.SWITCHCRAFT.COM) FOR THE MOST UP-TO-DATE PRODUCT SPECIFICATIONS

## MULTI-CON-X® INSTA-CLICK® LINE



**CABLE END - SOCKET**  
MATES WITH PANEL MOUNT AND  
CABLE TO CABLE



**CABLE END - PIN**  
MATES WITH PANEL MOUNT AND  
CABLE TO CABLE



**CABLE TO CABLE / INLINE - SOCKET**  
MATES WITH CABLE END



**PANEL MOUNT - PIN**  
MATES WITH CABLE END



**PANEL MOUNT - SOCKET**  
MATES WITH CABLE END



**CABLE TO CABLE / INLINE - PIN**  
MATES WITH CABLE END



**MOLDED CABLE END ASSEMBLY**



**MOLDED CABLE TO CABLE ASSEMBLY**



**MOLDED RIGHT ANGLE CABLE ASSEMBLY**

# Multi-Con-X® Insta-Click® Sealed Connectors

## FIELD INSTALLABLE KITS

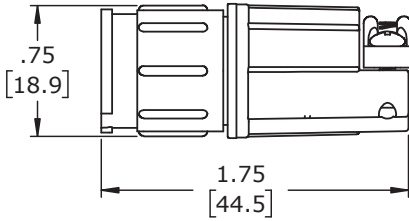

W5XXX-XXG-P-5XX  
FIELD INSTALLABLE  
CABLE TO CABLE  
CONNECTOR  
THREADED BACKSHELL  
TYPE 5-LONG

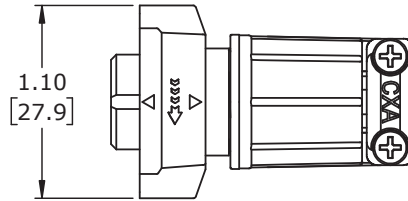

W3XXX-XXG-P-5XX  
FIELD INSTALLABLE  
CABLE CONNECTOR  
THREADED BACKSHELL  
TYPE 5-LONG

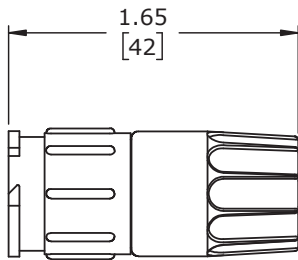

W5X82-XXG-P-3XX  
FIELD INSTALLABLE  
CABLE TO CABLE  
CONNECTOR  
THREADED BACKSHELL  
TYPE 3-LONG  
(SOLDER TYPE CONTACT ONLY)

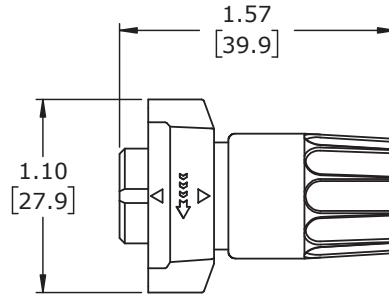

W3X82-XXG-P-3XX  
FIELD INSTALLABLE  
CABLE CONNECTOR  
THREADED BACKSHELL  
TYPE 3-LONG  
(SOLDER TYPE CONTACT ONLY)

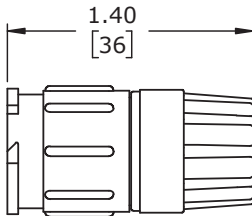

W5X80-XXG-P-3XX  
FIELD INSTALLABLE  
CABLE TO CABLE  
CONNECTOR  
THREADED BACKSHELL  
TYPE 3-SHORT  
(CRIMP TYPE CONTACT ONLY)

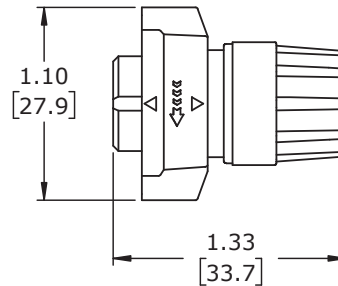

W3X80-XXG-P-3XX  
FIELD INSTALLABLE  
CABLE CONNECTOR  
THREADED BACKSHELL  
TYPE 3-SHORT  
(CRIMP TYPE CONTACT ONLY)

## PANEL MOUNT ASSEMBLY KITS

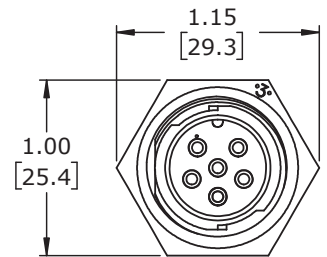
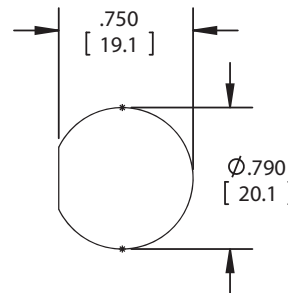
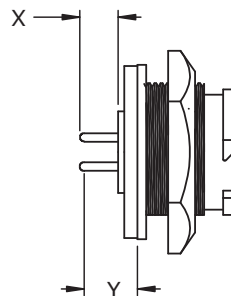
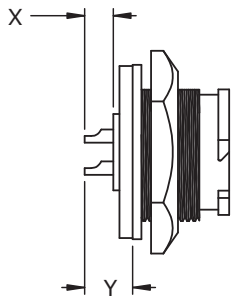
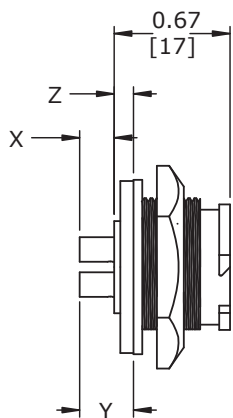

RECOMMENED  
PANEL CUT-OUT  
TOLERANCE:  $\pm 0.003$  [0.08]

All dimensions are for reference only. Units shown: in [mm]. Contact factory for X, Y, Z dimensions.

## PANEL MOUNT / CABLE TO CABLE CONNECTORS

### Front View | Wire View

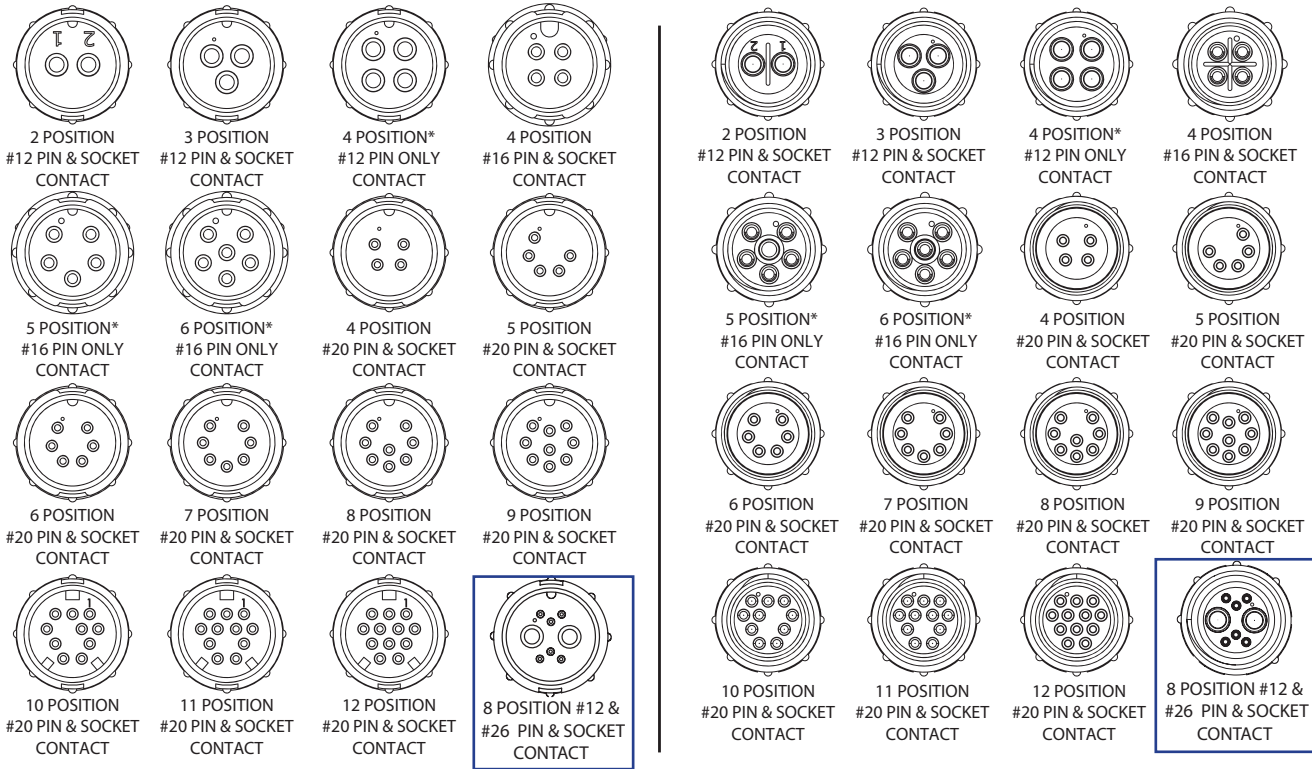

## CABLE CONNECTORS

### Front View | Wire View

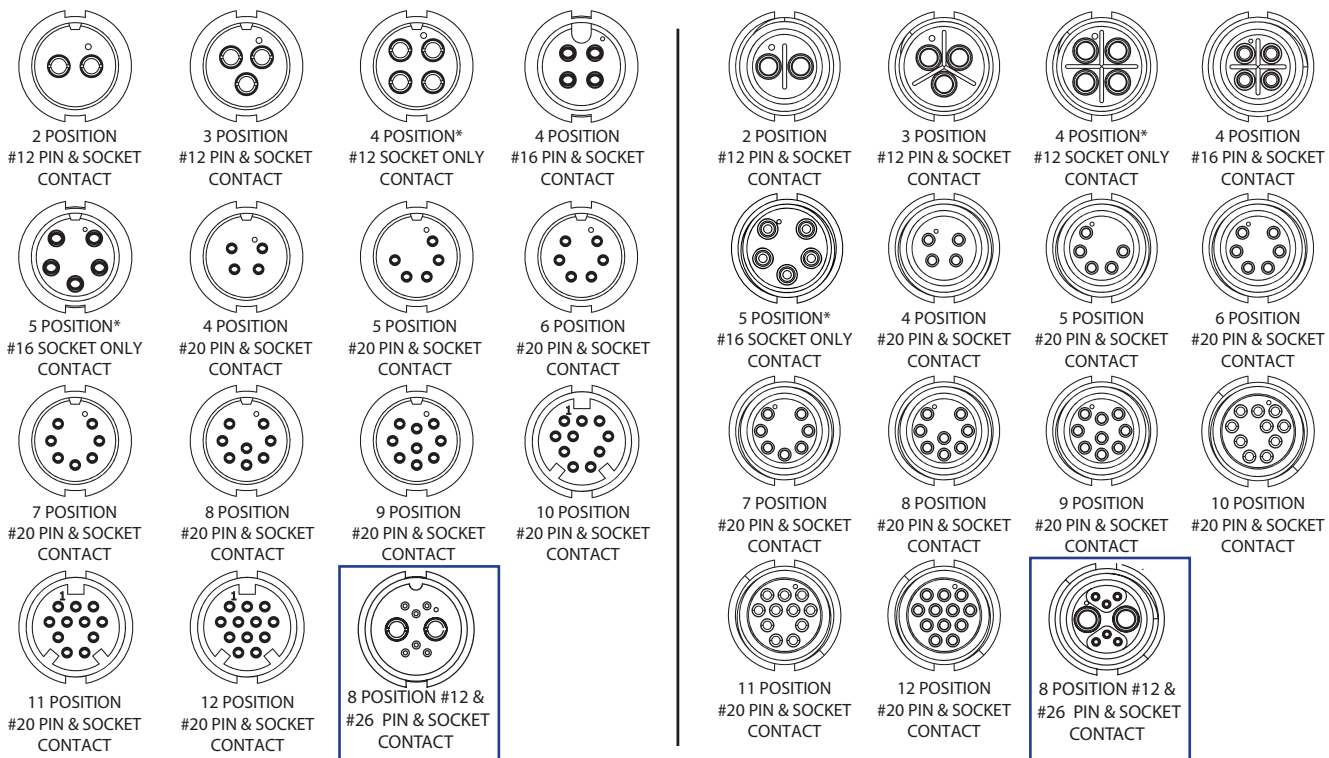

## PART NUMBER TO ORDER: MULTI CON X® INSTA-CLICK®

W X X XX XXG - P - XXX - W

Material Type

**“W”** - UV Resistant Material

Special Features

**“W”** - Winged Coupling Nut

Connector Type

- 3** - Cable End
- 4** - Panel mount
- 5** - Cable to Cable

Backshell Style

(Cable O.D. Range)

**3XX**: Weahertight Grommet Grip Seal

**5XX**: Mechanical Screw-Down Cable Clamp with Grommet Style

**“15”** - 0.15” - 0.17”

**“18”** - 0.18” - 0.20”

**“21”** - 0.21” - 0.23”

**“24”** - 0.24” - 0.27”

**“28”** - 0.28” - 0.29”

**“30”** - 0.30” - 0.32”

**“35”** - 0.35” - 0.37”

**3DC**: Daisy Chian Grommet w/ 3 IDS  
(0.125”, 0.188”, 0.250”)

Contact Size

- 1** - #12
- 2** - #20
- 3** - #16
- B** - #12 / #26 Mixed

Panel Mount

**300** - w/ Hex Nut & Gasket

**3ES** - 300 with Epoxy

Contact Style

- 8X** - **“0”** - Crimp (supplied loose)
- “1”** - #20 PC Tail Short\*
- “2”** - Solder Cup

Latching Style

**“P”** - Insta-Click® Positive Lock

**9X** - Extended PC Tail

- “1”** - #20 PC Tail Medium\*
- “2”** - #20 PC Tail Long\*

Gold Plated

No. & Type of Contacts

Pins or **Socket**

**\*Consult factory for length and diameter of PC Tail.  
Additionally, alternative colors and materials are available.**

## SCREW TERMINALS OPTION

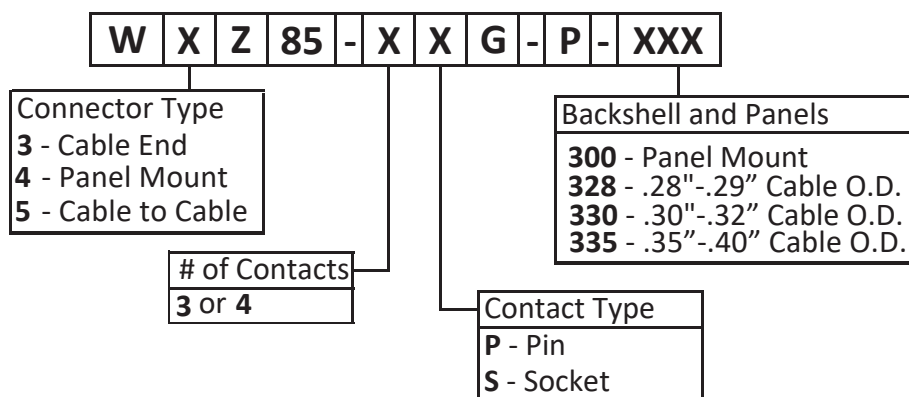
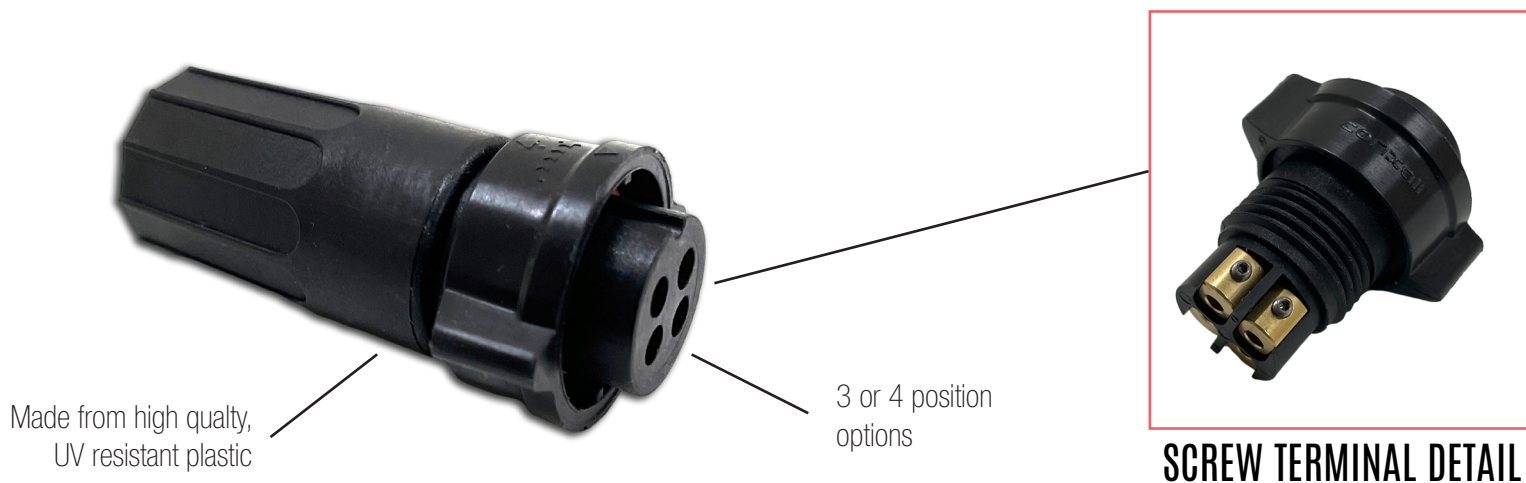

## EXTRA LARGE BACKSHELL ADAPTER



PART NO.	RECOMMENDED CABLE O.D. SIZE
4284-542AD-KIT	0.40-0.43" [10.2-10.9mm]
4284-556AD-KIT	0.54-0.57" [13.7-14.5mm]

# Multi-Con-X® Insta-Click® Sealed Connectors

## SPECIFICATIONS

### MECHANICAL:

Life:	300 insertion / withdrawal cycles minimum
Hex Nut Torque:	10 in-lb tightening torque
Coupling Locking Style:	Spring activated positive lock
Backshell Style:	Threaded
Conductor Sizes:	#12 accepts 12 through 14 AWG #16 contacts accepts 16 through 18 AWG #20 contacts accepts 20 through 24 AWG

### ELECTRICAL:

Voltage Rating:	300 V AC/DC
Current Rating:	23A Max (current rating varies by contact configuration, see website or contact factory for details)

### ENVIRONMENTAL:

Operating Temperature:	-40°C to +85°C (-40°F to +185°F)
Salt Atmosphere (Corrosion) :	300 Hr salt spray when mated
Weathertight:	IP66, IP67, IP68 per IEC60529 (Molded cable assemblies , consult factory)

### MATERIAL:

Backshell:	High-PBT Thermoplastic, Black
Contacts:	Copper Alloy, Gold over Nickel Plate
Coupling Ring:	High-PBT Thermoplastic, Black
Gasket:	Elastomer, Black
Grommet/ Strain Relief:	Elastomer, Black
Hex Nut:	High-PBT Thermoplastic, Black
O-Ring:	Silicone, Red
Shell:	High-PBT Thermoplastic, Black